

FITTINGS 15K PSI (1000 BAR)

HEX NIPPLES — PIPE THREAD (NPT)

- Stainless steel

| PART NO. | CONNECTION TYPES | | MAXIMUM OPERATING PRESSURE | |
|---------------|------------------|----------------|----------------------------|------|
| | Connection 1 | Connection 2 | psi | bar |
| GP 055-P1P1 | 1/16" NPT Male | 1/16" NPT Male | 15k | 1000 |
| GP 055-P1P2 | 1/8" NPT Male | 1/16" NPT Male | 15k | 1000 |
| GP 055-P1P4 | 1/4" NPT Male | 1/16" NPT Male | 15k | 1000 |
| GP 055-P2P2 | 1/8" NPT Male | 1/8" NPT Male | 15k | 1000 |
| GP 055-P2P4 | 1/4" NPT Male | 1/8" NPT Male | 15k | 1000 |
| GP 055-P2P6 | 3/8" NPT Male | 1/8" NPT Male | 15k | 1000 |
| GP 055-P2P8 | 1/2" NPT Male | 1/8" NPT Male | 15k | 1000 |
| GP 055-P4P4 | 1/4" NPT Male | 1/4" NPT Male | 15k | 1000 |
| GP 055-P4P6 | 3/8" NPT Male | 1/4" NPT Male | 15k | 1000 |
| GP 055-P4P8 | 1/2" NPT Male | 1/4" NPT Male | 15k | 1000 |
| GP 055-P4P12 | 3/4" NPT Male | 1/4" NPT Male | 15k | 1000 |
| GP 055-P6P6 | 3/8" NPT Male | 3/8" NPT Male | 12k | 830 |
| GP 055-P6P8 | 1/2" NPT Male | 3/8" NPT Male | 15k | 1000 |
| GP 055-P6P12 | 3/4" NPT Male | 3/8" NPT Male | 15k | 1000 |
| GP 055-P8P8 | 1/2" NPT Male | 1/2" NPT Male | 12k | 830 |
| GP 055-P8P12 | 3/4" NPT Male | 1/2" NPT Male | 15k | 1000 |
| GP 055-P8P16 | 1" NPT Male | 1/2" NPT Male | 12k | 830 |
| GP 055-P12P12 | 3/4" NPT Male | 3/4" NPT Male | 12k | 830 |
| GP 055-P12P16 | 1" NPT Male | 3/4" NPT Male | 10k | 700 |
| GP 055-P16P16 | 1" NPT Male | 1" NPT Male | 10k | 700 |

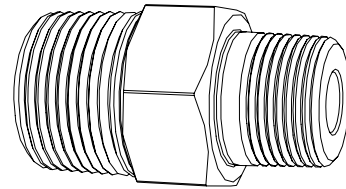

PIPE THREAD MALE (NPT MALE) TO TYPE M MALE ADAPTERS

- Stainless steel

| PART NO. | CONNECTION TYPES | | MAXIMUM OPERATING PRESSURE | |
|------------|---------------------|---------------|----------------------------|------|
| | Connection 1 | Connection 2 | psi | bar |
| AF 060-P4 | 9/16" Type M Male | 1/4" NPT Male | 15k | 1000 |
| AF 060-P6 | 9/16" Type M Male | 3/8" NPT Male | 15k | 1000 |
| AF 060-P8 | 9/16" Type M Male | 1/2" NPT Male | 15k | 1000 |
| AF 060-P12 | 9/16" Type M Male | 3/4" NPT Male | 15k | 1000 |
| AF 061-P4 | 3/4" Type M Male | 1/4" NPT Male | 15k | 1000 |
| AF 061-P8 | 3/4" Type M Male | 1/2" NPT Male | 15k | 1000 |
| AF 061-P12 | 3/4" Type M Male | 3/4" NPT Male | 15k | 1000 |
| AF 063-P8 | 1" Type M Male | 1/2" NPT Male | 15k | 1000 |
| AF 063-P12 | 1" Type M Male | 3/4" NPT Male | 15k | 1000 |
| AF 063-P16 | 1" Type M Male | 1" NPT Male | 12k | 830 |
| AF 064-P12 | 1-5/16" Type M Male | 3/4" NPT Male | 15k | 1000 |
| AF 064-P16 | 1-5/16" Type M Male | 1" NPT Male | 12k | 830 |

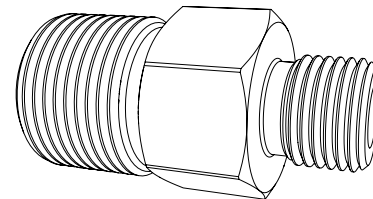

FITTINGS 15K PSI (1000 BAR)

PIPE THREAD MALE (NPT MALE) TO MEDIUM PRESSURE (MP) MALE ADAPTERS

- Stainless steel

| PART NO. | CONNECTION TYPES | | MAXIMUM OPERATING PRESSURE | |
|----------------|------------------|---------------|----------------------------|------|
| | Connection 1 | Connection 2 | psi | bar |
| AF 068-MP6P4 | 3/8" MP Male | 1/4" NPT Male | 15k | 1000 |
| AF 068-MP6P6 | 3/8" MP Male | 3/8" NPT Male | 15k | 1000 |
| AF 068-MP6P8 | 3/8" MP Male | 1/2" NPT Male | 15k | 1000 |
| AF 068-MP9P4 | 9/16" MP Male | 1/4" NPT Male | 15k | 1000 |
| AF 068-MP9P6 | 9/16" MP Male | 3/8" NPT Male | 15k | 1000 |
| AF 068-MP9P8 | 9/16" MP Male | 1/2" NPT Male | 15k | 1000 |
| AF 068-MP9P12 | 9/16" MP Male | 3/4" NPT Male | 15k | 1000 |
| AF 068-MP9P16 | 9/16" MP Male | 1" NPT Male | 12k | 830 |
| AF 068-MP12P8 | 3/4" MP Male | 1/2" NPT Male | 15k | 1000 |
| AF 068-MP12P12 | 3/4" MP Male | 3/4" NPT Male | 15k | 1000 |
| AF 068-MP12P16 | 3/4" MP Male | 1" NPT Male | 12k | 830 |
| AF 068-MP16P8 | 1" MP Male | 1/2" NPT Male | 15k | 1000 |
| AF 068-MP16P12 | 1" MP Male | 3/4" NPT Male | 15k | 1000 |
| AF 068-MP16P16 | 1" MP Male | 1" NPT Male | 12k | 830 |

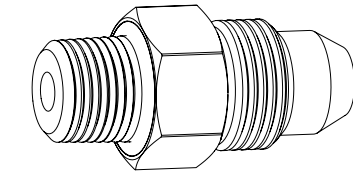

PIPE THREAD FEMALE (NPT FEMALE) TO MEDIUM PRESSURE (MP) MALE ADAPTERS

- Stainless steel

| PART NO. | CONNECTION TYPES | | MAXIMUM OPERATING PRESSURE | |
|----------------|------------------|-----------------|----------------------------|------|
| | Connection 1 | Connection 2 | psi | bar |
| AF 065-MP6P6 | 3/8" MP Male | 3/8" NPT Female | 15k | 1000 |
| AF 065-MP6P8 | 3/8" MP Male | 1/2" NPT Female | 15k | 1000 |
| AF 065-MP9P2 | 9/16" MP Male | 1/8" NPT Female | 15k | 1000 |
| AF 065-MP9P4 | 9/16" MP Male | 1/4" NPT Female | 15k | 1000 |
| AF 065-MP9P6 | 9/16" MP Male | 3/8" NPT Female | 15k | 1000 |
| AF 065-MP9P8 | 9/16" MP Male | 1/2" NPT Female | 15k | 1000 |
| AF 065-MP12P8 | 3/4" MP Male | 1/2" NPT Female | 15k | 1000 |
| AF 065-MP12P12 | 3/4" MP Male | 3/4" NPT Female | 15k | 1000 |
| AF 065-MP16P8 | 1" MP Male | 1/2" NPT Female | 15k | 1000 |
| AF 065-MP16P12 | 1" MP Male | 3/4" NPT Female | 15k | 1000 |

